

**LAYOUT
SAURASHTRA
PLAST 2025**

23 24 25 26

APRIL 2025

-: VENUE :-

Race Course Maidan, Rajkot.

**4th Edition
Saurashtra
Plast
2025**

Organized By



Event Partner



Sponsor By



Supported By

SPECIAL DISCOUNT 20%

EARLY BIRD DISCOUNT 10%*

(Before 15th January 2025)*

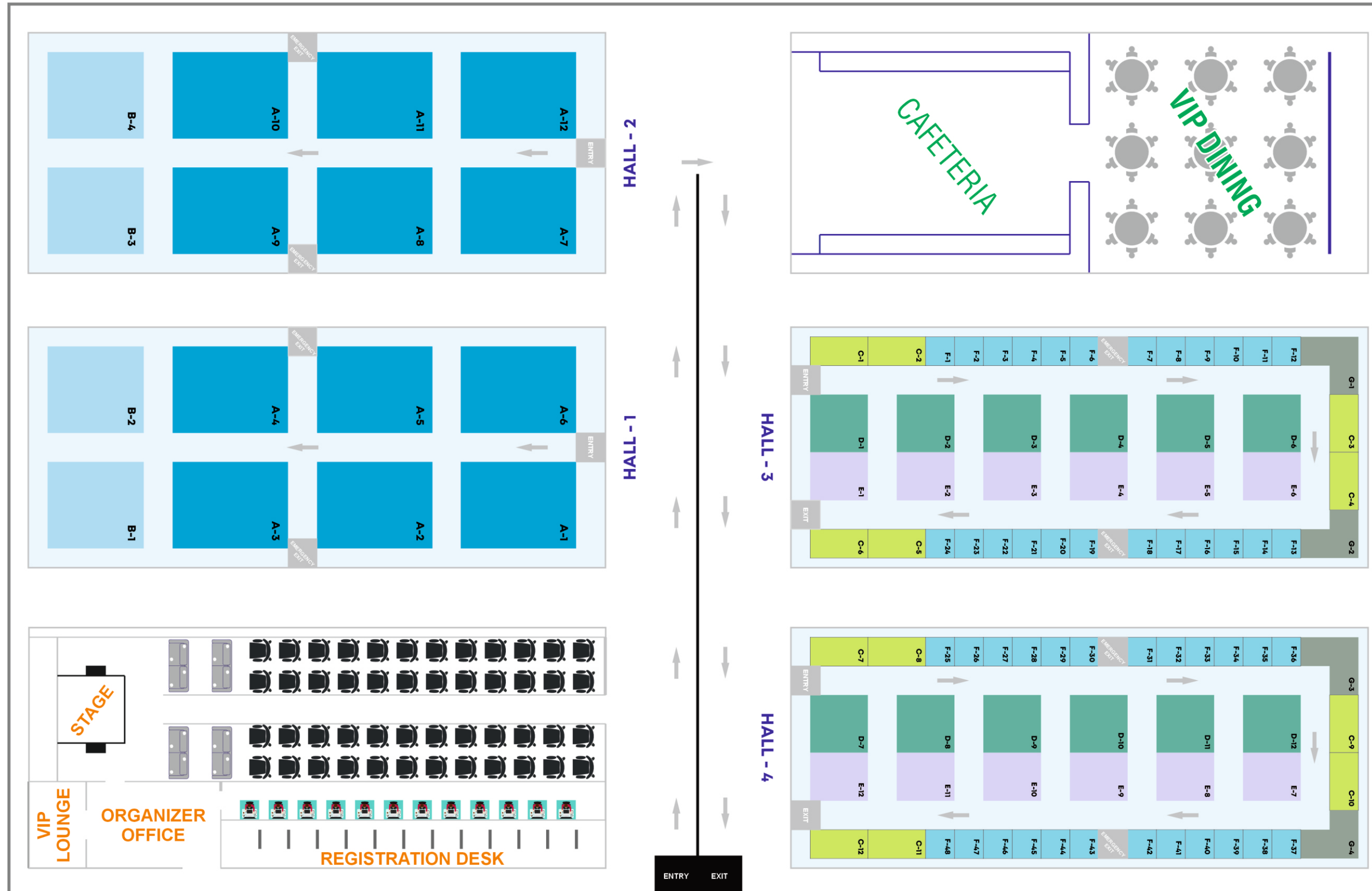

SHELL SCHEME

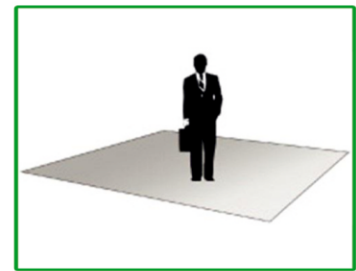

BARE SPACE

CATEGORY	RATE
SHELL SCHEME	9000/- sq. mtr
BARE SPACE	8000/- sq. mtr

- GST WILL BE CHARGED EXTRA @18%
- ONLY SPACE (BARE SPACE)

FACILITIES

EXHIBITION IN AIR CONDITION
TABLE, CHAIR, SPOT LIGHT,
5 AMP PLUG SOCKET)
WILL BE PROVIDED AS PER STALL SIZE IN
SHELL SCHEME.

CATEGORY	SIZE
A	12x9 = 108 sq. mtr
B	10x9 = 90 sq. mtr
C	6x3 = 18 sq. mtr
D	6x6 = 36 sq. mtr
E	6x5 = 30 sq. mtr
F	3x3 = 9 sq. mtr
G	5x3 = 15 sq. mtr